

RoHS

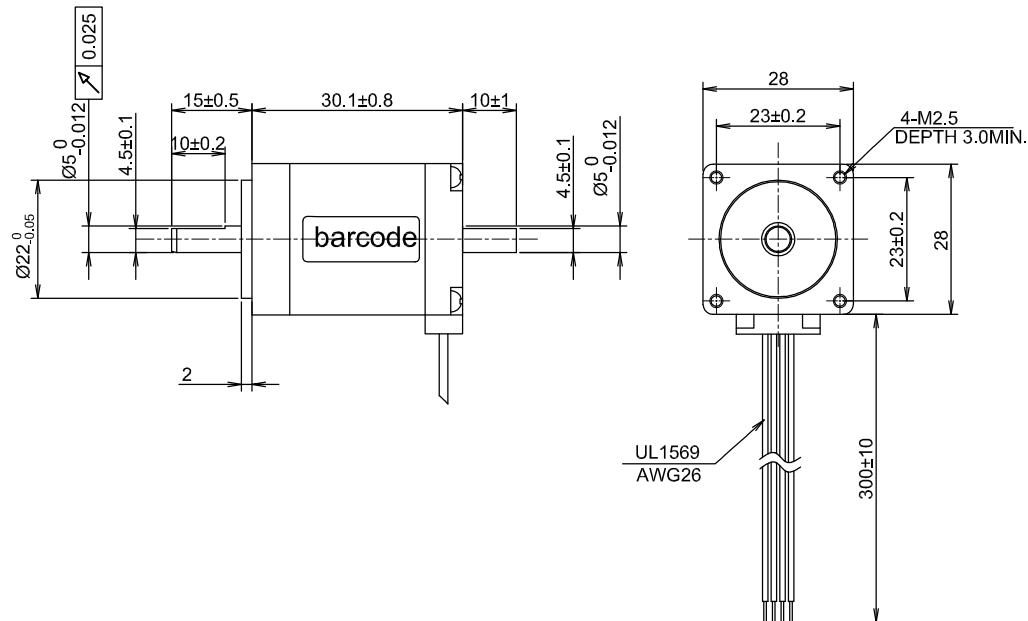

接线图/Connection

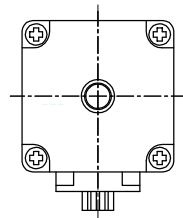
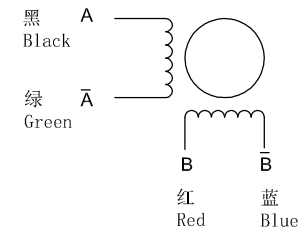

励磁顺序（两相励磁）VS 旋转方向
EXCITING SEQUENCE (TWO PHASES)
VS. DIRECTION OF ROTATION

STEP	A	B	\bar{A}	\bar{B}	CCW
1	+	+	-	-	↑
2	-	+	+	-	
3	-	-	+	+	
4	+	-	-	+	

从电机安装面看为顺时针
Clock wise from motor shaft side

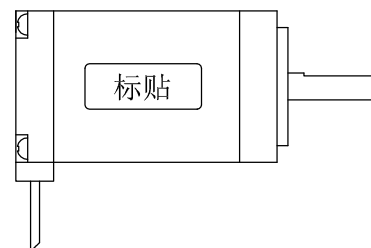

YYWWXXXX

Stator barcode label



电机参数/Motor parameters

步进角/Step angle	1.8°±5%
额定电流/Rated current	1.0 Amps/PHASE
保持力矩/Holding torque	0.08 N.m MIN.
电阻/Resistance	4.5 ohm±10% AT 25°C
电感/Inductance	4.0 mH±20% AT 1kHz, 1Vrms
转子惯量/Rotor inertia	5g.cm ²
绝缘等级/Insulation class	CLASS B
绝缘耐压/Insulation strength	500V A.C 1MINUTE
防护等级/IP protection	IP 20
重量/Weight	100g
温升/Temperature rising	80K MAX.
额定运行环境温度/Operation temperature	-20°C—+50°C
允许轴向负载/Axial load	10N
允许径向负载/Radial load	21N (ON THE SHAFT END)

电机型号

EW11-110D

步进电机规格书

单位: mm

未标注长度及角度默认公差

长度: ±0.3mm 角度: ±5%

电机检验标准: QC-ZL-011

版本	日期	描述	出图人
A	13-12-21	first version	BUD
APPROVED			John