

RoHS

接线图 WINDING DIAGRAM

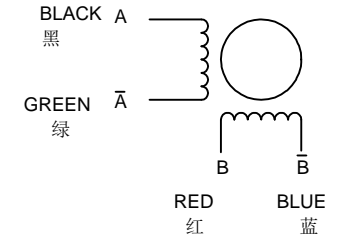

励磁顺序 (两相励磁) VS 旋转方向
EXCITING SEQUENCE (TWO PHASES)
VS. DIRECTION OF ROTATION

	STEP	A	B	\bar{A}	\bar{B}	
	1	+	+	-	-	CCW
	2	-	+	+	-	
	3	-	-	+	+	
	4	+	-	-	+	CW

从电机安装面看为顺时针
CLOCK WISE VIEW FROM MOUNTING SIDE

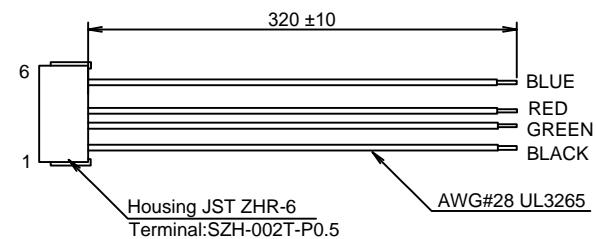
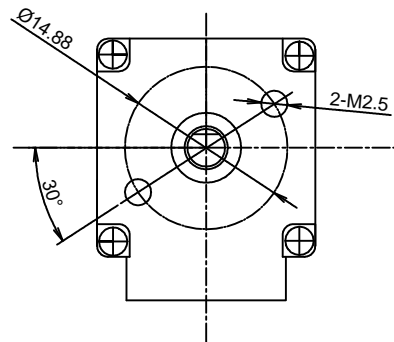
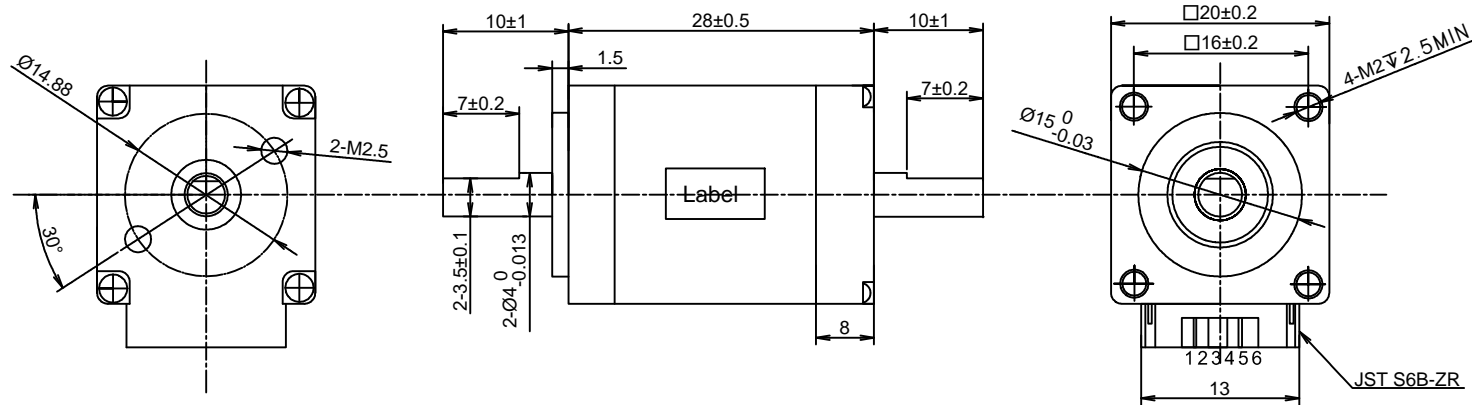

YYWWXXXXX

Stator barcode label

电机参数 MOTOR SPECIFICATIONS

步进角 STEP ANGLE	1.8°±5%
额定电流 RATED CURRENT	0.6 Amps/PHASE
保持力矩 HOLDING TORQUE	0.02N.m
电阻 RESISTANCE	6.5 ohm±0.15AT 25°C
电感 INDUCTANCE	2.2 mH±20% AT 1kHz, 1Vrms
转子惯量 ROTOR INERTIA	1.6 g·cm ²
绝缘等级 INSULATION CLASS	CLASS B
绝缘耐压 DIELECTRIC STRENGTH	500V A.C 1MINUTE
防护等级 IP CODE	
丝杆直径 Lead screw diameter	
螺纹导程 Lead	
重量 Weight	0.04kg
工作环境温度 Operating temperature	-20°C ~ +50°C
温升 Heat rise	80K

注 黑色端盖
NOTE: BLACK ENDBELLS

电机型号 MOTOR CODE

EW08-106D

步进电机规格书

UNIT: mm
UNLESS OTHERWISE SPECIFIED TOLERANCES /DIMENSIONS : ±0.3mm /DEGREES : ±5%
电机检验标准 / Motor inspection standard: QC-ZL-011

REV.	DATE	REVISIONS	BY
A	14-06-22	first version	Luffy

APPROVED
John

