

RoHS

A
B
C
D
E

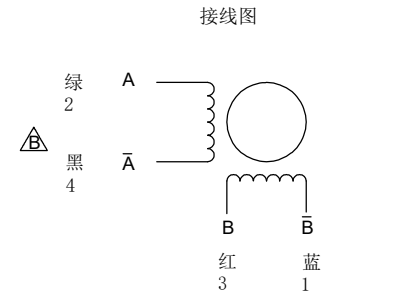

编码器接线		端子序号
黑	GND	10
红	+5V	9
蓝白	A/	8
蓝	A	7
橙白	B/	6
橙	B	5

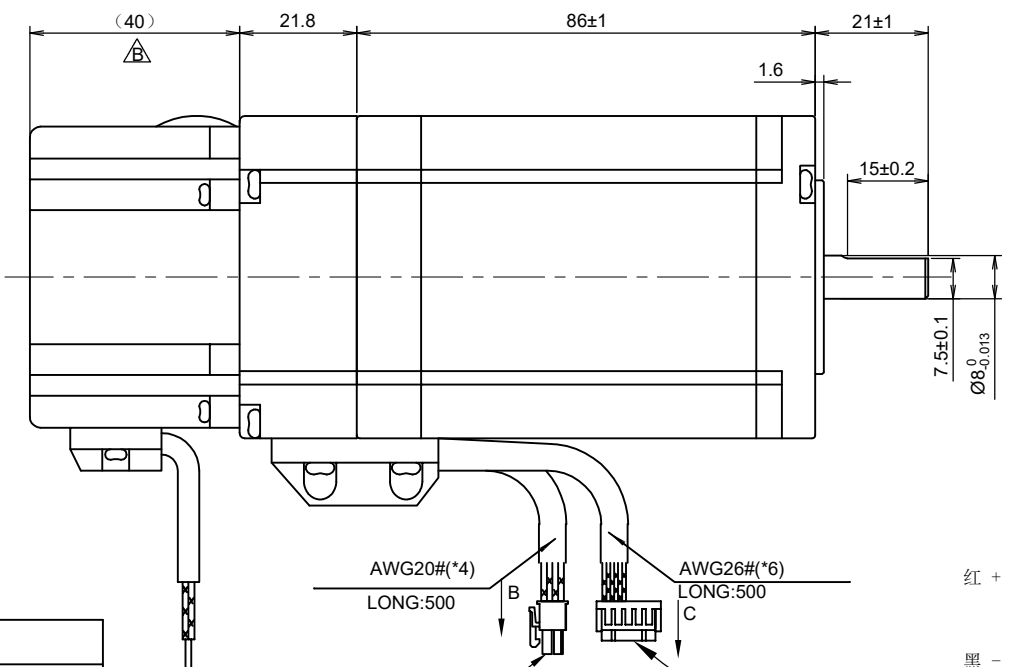
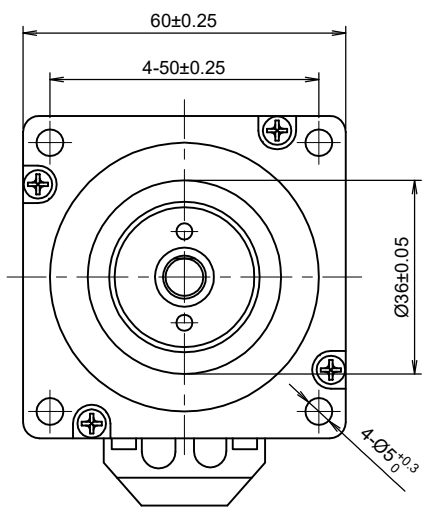
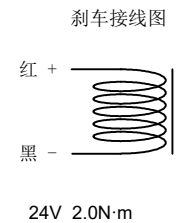
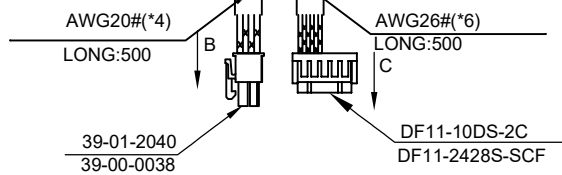

励磁顺序 (两相励磁) VS 旋转方向

STEP	A	B	A-bar	B-bar	CCW
1	+	+	-	-	↑
2	-	+	+	-	↓
3	-	-	+	+	↑
4	+	-	-	+	↓

从电机安装面看为顺时针

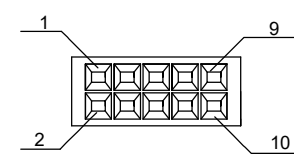
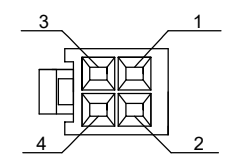
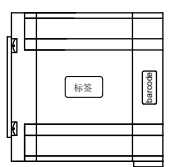

YYWWXXXX
Stator barcode label

注 黑色端盖

编码器参数	
分辨率	1000ppr
额定电压	5 Vdc
输出类型	line driver
电机参数	
步进角	1.8°±5%
额定电流	5.0 Amps/PHASE
保持力矩	3.0 N.m MIN.
电阻	0.46 ohm±0.1 AT 25°C
电感	2.0 mH±20% AT 1kHz, 1Vrms
转子惯量	900g.cm ²
绝缘等级	CLASS B
绝缘耐压	500V A.C 1MINUTE
防护等级	IP 20
重量	1500g
温升	80K MAX.
额定运行环境温度	-20°C---+50°C
允许轴向负载	15N
允许径向负载	75N (ON THE SHAFT END)

电机型号
EW24-450M-E1000
步进电机规格书

单位: mm
未标注长度及角度默认公差
长度: ±0.3mm 角度: ±5%
电机检验标准: QC-ZL-011
编码器检验标准: QC-ZL-013

版本	日期	描述	出图人
B	18-05-21	修改端子线序	BUD
A	02-03-21	first version	BUD



APPROVED
John